

PRODUCT DATA SHEET

RS050613-12V05-2835S-120



IP67

Product Features

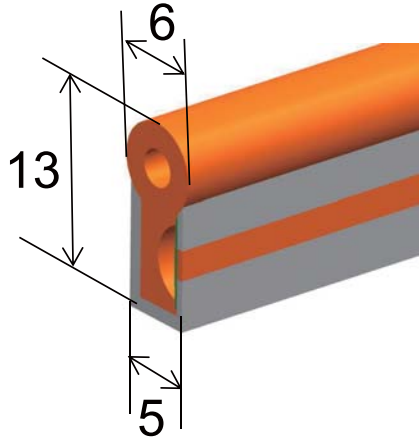

Application

1. Silicagel material, high temperature resistance, yellowing resistance, can be used in outdoor harsh weather.
2. Good flexibility, good bending, easy modeling and anti pulling force.
3. Corrosion resistance, acid and alkali can be used in extremely harsh conditions.
4. Uniform lamination, no spot, light effect is soft.
5. High brightness chip LED, pure gold wire, pure copper packaging, good heat dissipation, high stability, long service time.
6. Lead free SMT process (RoHS), smooth solder joints, solid and reliable connection.

Structure Introduction

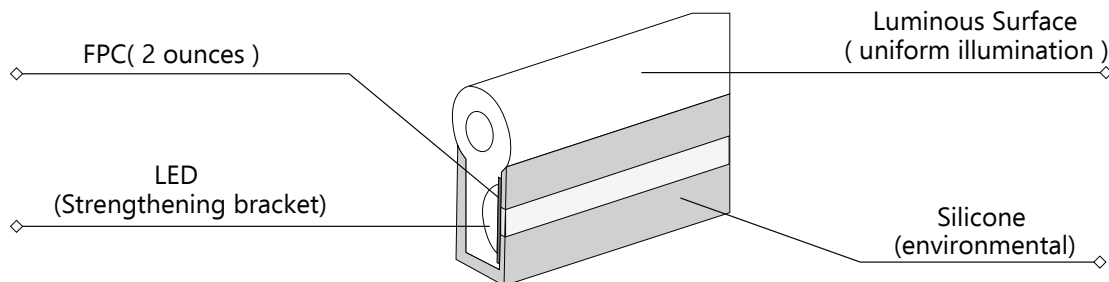

Product Information





Diagram

Dimension (mm)

Length/Reel	Width	Height	Min. Cutting ✂
5m/10m/15m	5mm	1.65mm	Every 25 mm (3 LEDs)

Data

Part Number	Working Voltage	Power	Current	Qty	CRI
RS050613-12V05-2835S-120	12V	10W/m	0.8365A/m	120leds/m	80+

CCT (°K)	Luminous Efficiency	Color	lumen/m
2700K	517.5lm/W	Extra Warm 	51.75lm/m
3000K	517.5lm/W	Warm White 	51.75lm/m
4000K	544.5lm/W	Neutral White 	54.25lm/m
6000K	544.5lm/W	Cool White 	54.25lm/m

Note: The Lumen output value tolerance + -5% due to testing way.
The CCT will be + -200k tolerance.

Installation accessories



Silicone End Cap horizontal direction with Line



Silicone End Cap without Line



Aluminum Clip



Aluminum alloy End Cap without Line (with Screw hole)

Installation process

1. Cut according to the required length. The strip has a mark every 50cm. Cut at the mark position

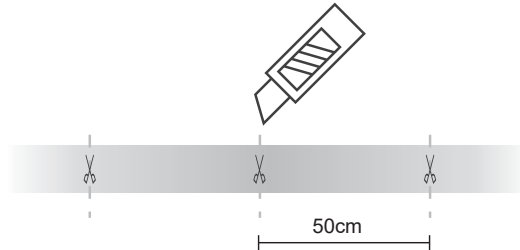

2. At the end of the outlet line, the inside of the plug and the outside of the strip are coated with special silica gel adhesive, and then put into the lamp band and use after 30 minutes.

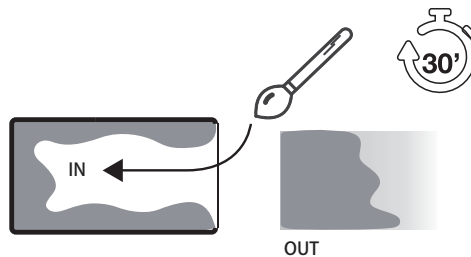

3. Need outlet: penetrate wire into the plug hole to the other end of the plug.

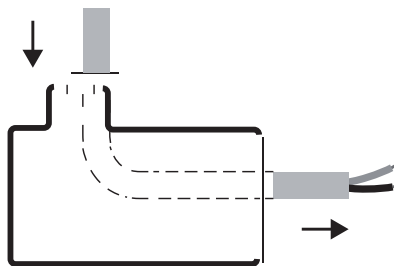

4. Weld wire through the plug on FPC, positive welding on(+), negative welding on(-)

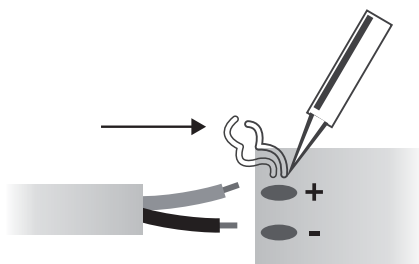

5. At the end of the outlet line, the inside of the plug and the outside of the strip are coated with special silica gel adhesive, and then put into the lamp band and use after 30 minutes.

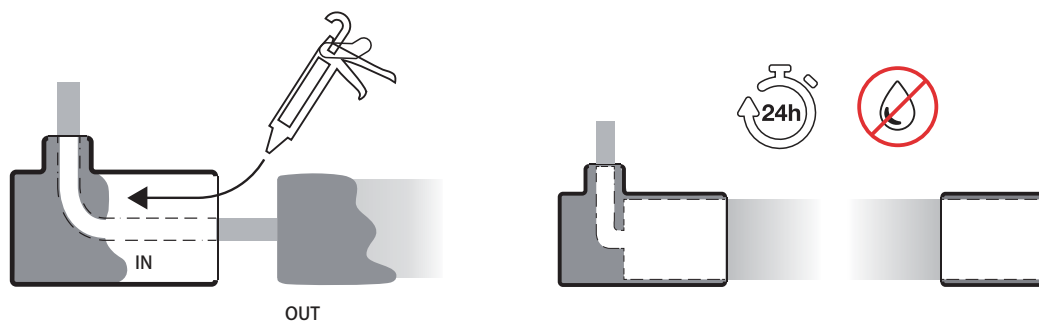

Installation of fix clip

1. Find the right screw to ensure that the head of the screw is not too high. Fix the fastener in the desired position. Finally, clip the strip in the slot.

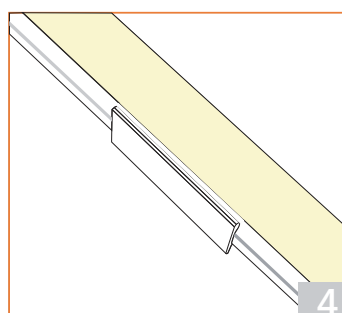
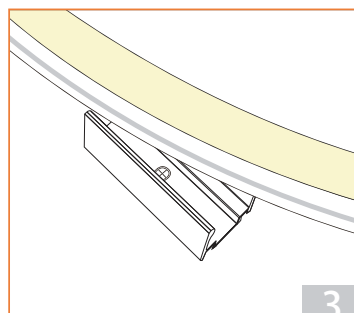
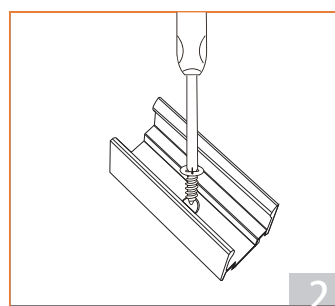
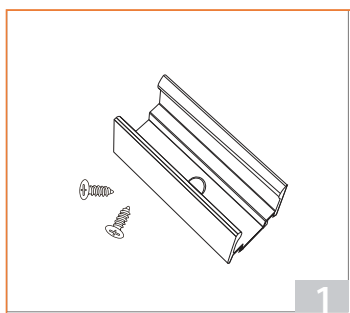

Wiring Diagram

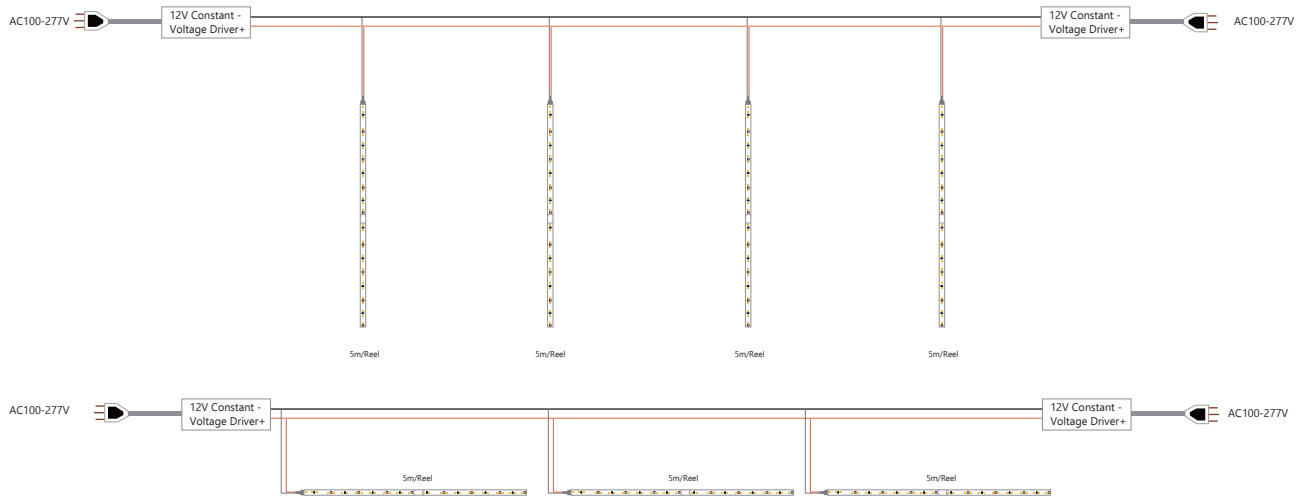

Packaging

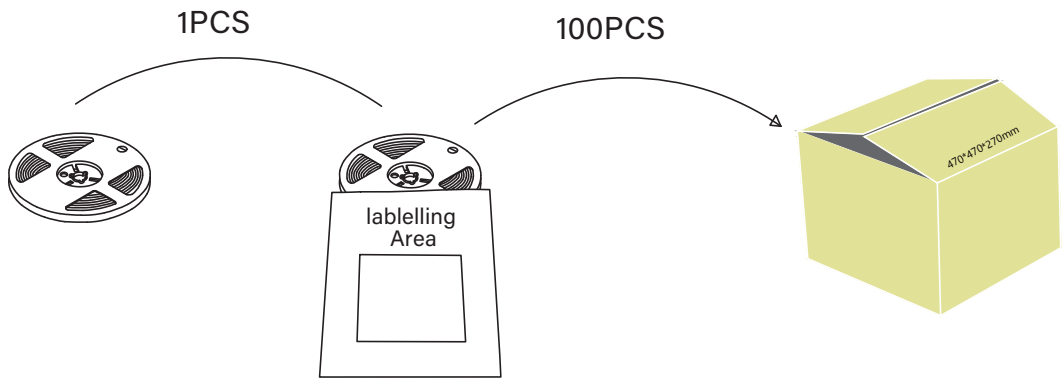

Attention

1. This product uses low voltage DC power supply, must use AC-DC switch. Use the power supply after voltage conversion! It is strictly forbidden to directly connect the LED light bar with AC 110V or AC 220V AC mains voltage connection, otherwise it will damage the strip, and may cause a safety accident!

2. Bending Direction Requirements: Bending neon strip is required to bend along the upper and lower directions of the cross section, bending in the left and right directions of the cross section or seriously twisting will damage the strip.

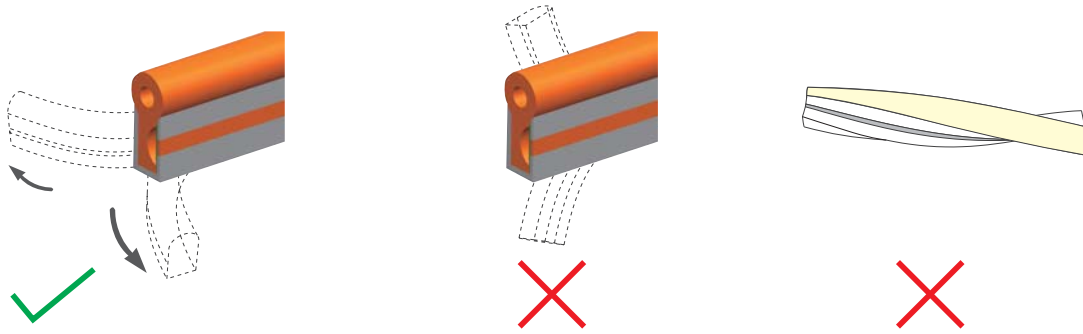

3. Minimum bending diameter: The minimum bending diameter of curved neon strip is not less than 50 mm, and the bending diameter is less than 50 mm, which will easily damage the strip.

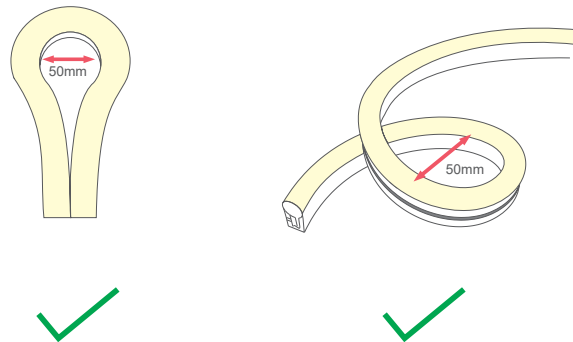

4. During installation and use, there is a possibility of soiling the light strip. You can use a cotton cloth, dip it in clean water or sprinkle it, and gently wipe the dirty location to clean it.

5. Do not touch the product by means of heavy knocking or hammering;
Do not pull the lamp belt forcefully to avoid breaking the FPC in the product;
Do not pull the power cord forcefully to avoid the disc falling off;
Pay attention to the wiring.

Safety & Disclosures

1. ▶ Do not install the led strip in environment where excessive heat may occur.
2. ▶ Do not extend beyond the recommended maximum run length.
3. ▶ Only use copper wiring. Use wires rated for at least 176°F(80°C) and certified for use with external connection of electrical equipment.
4. ▶ Do not install IP20 LED strip products in outdoor / wet location environments.
5. ▶ Excessive handling, bending, and pressure may damage the product, voiding the warranty.
6. ▶ Improper wire selection and installation could overheat wires, and cause fire.
7. ▶ Do not connect directly to high voltage or AC power.
8. ▶ Installation must be in accordance with local and national electrical code regulations.
9. ▶ To ensure safety and correct installation, our strips are intended to be installed by a qualified, licensed electrician.